

Vue en plan

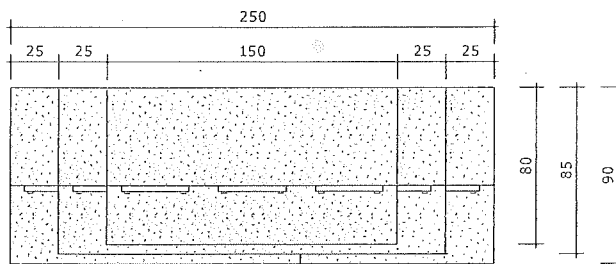

Vue de face

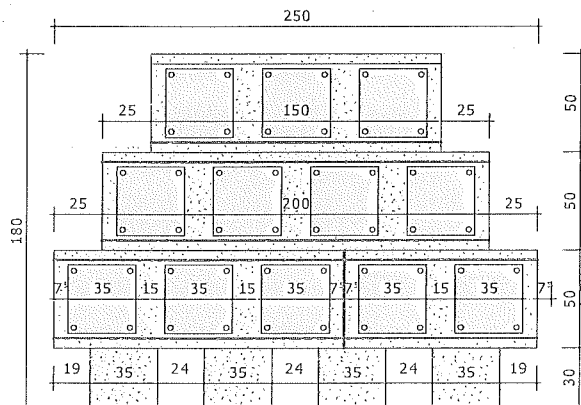

Vue gauche

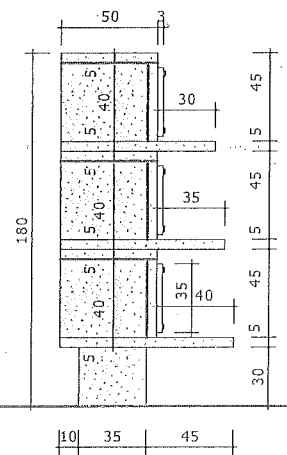

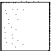
-  Finition polie
-  Finition flammée

Poids : 2605 kg  
 Dimensions : L 250 x l 90 x ht 180  
 Portes : polies  
 P60053 - (12) x 35 x 35 x 3 ep

Images, photos et couleurs non contractuelles - Modèle OGF - 05/2012



**OGF**

Collectivités

DIRECTION DU MARKETING

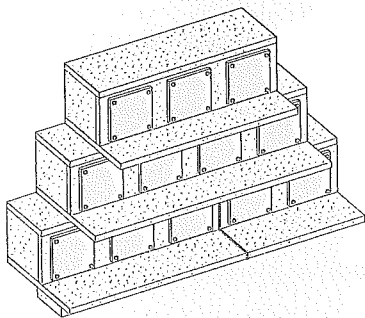
Réf. TG :	<b>P60***</b>		
Modèle :	<b>ALMERA - 12 cases</b>		
DATE: 02/05/2012	Note	-----	Fiche 1/2



-  Finition polie
-  Finition flammée

Poids : 2605 kg  
 Dimensions : L 250 x l 90 x ht 180  
 Portes : polies  
 P60053 - (12) x 35 x 35 x 3 ep

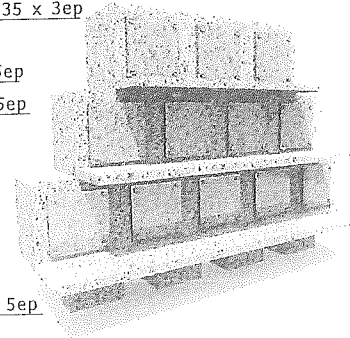
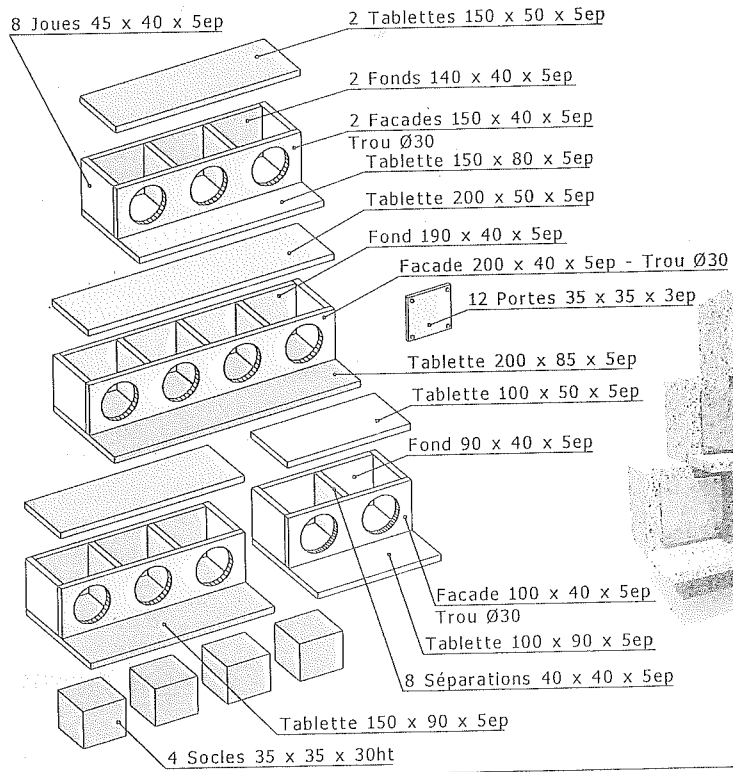

Images, photos et couleurs non contractuelles - Modèle OGF - 05/2012

 Collectivités	<b>DIRECTION DU MARKETING</b>		Réf. TG : <b>P60***</b>	Fiche 2/2
	DATE: 02/05/2012		Modèle <b>ALMERA - 12 cases</b>	